

**BUILDING-STRUCTURE INVENTORY FORM**

DIVISION FOR HISTORIC PRESERVATION  
 NEW YORK STATE PARKS AND RECREATION  
 ALBANY, NEW YORK (518) 474-0479

FOR OFFICE USE ONLY  
 UNIQUE SITE NO. 030-40 5093 DO7  
 QUAD \_\_\_\_\_  
 SERIES \_\_\_\_\_  
 NEG. NO. \_\_\_\_\_

YOUR NAME: BUFFALO FRIENDS OF OL MSTED PARKS DATE: March 30, 1984  
 P. O. BOX 590

YOUR ADDRESS: BUFFALO, NEW YORK 14205-0590 TELEPHONE: \_\_\_\_\_

ORGANIZATION (if any): \_\_\_\_\_

\*\*\*\*\*

**IDENTIFICATION**

1. BUILDING NAME(S): \_\_\_\_\_
2. COUNTY: Erie TOWN/CITY: Buffalo VILLAGE: \_\_\_\_\_
3. STREET LOCATION: 170 Woodward Ave
4. OWNERSHIP: a. public  b. private
5. PRESENT OWNER: Wallace Thompson ADDRESS: 170 Woodward
6. USE: Original: Residential Present: Residential
7. ACCESSIBILITY TO PUBLIC: Exterior visible from public road: Yes  No   
 Interior accessible: Explain by permission

**DESCRIPTION**

8. BUILDING MATERIAL: a. clapboard  b. stone  c. brick  d. board and batten   
 e. cobblestone  f. shingles  g. stucco  other: \_\_\_\_\_
9. STRUCTURAL SYSTEM: a. wood frame with interlocking joints   
 (if known) b. wood frame with light members   
 c. masonry load bearing walls   
 d. metal (explain) \_\_\_\_\_  
 e. other \_\_\_\_\_
10. CONDITION: a. excellent  b. good  c. fair  d. deteriorated
11. INTEGRITY: a. original site  b. moved  if so, when? \_\_\_\_\_  
 c. list major alterations and dates (if known):  
Remodeled into 2 family in 1943

12. PHOTO: 21-9a



13. MAP:

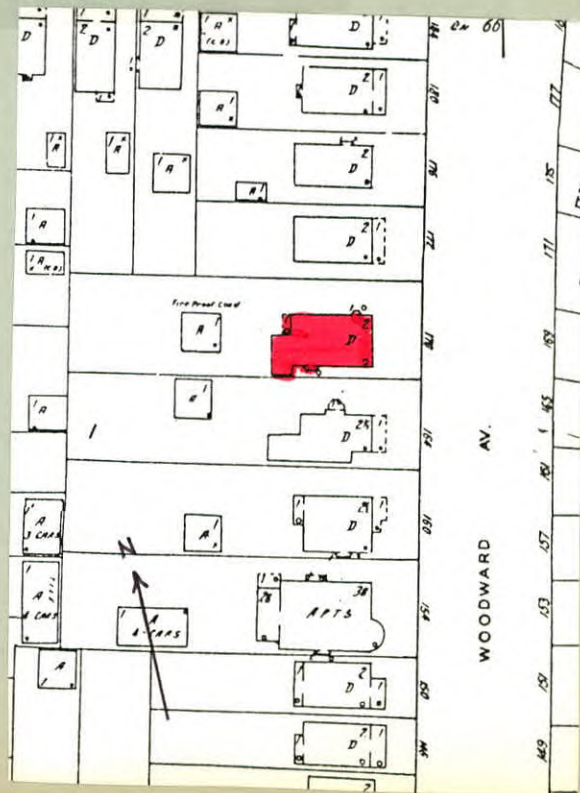



14. THREATS TO BUILDING: a. none known  b. zoning  c. roads   
 d. developers  e. deterioration   
 f. other: \_\_\_\_\_
15. RELATED OUTBUILDINGS AND PROPERTY:  
 a. barn  b. carriage house  c. garage   
 d. privy  e. shed  f. greenhouse   
 g. shop  h. gardens   
 i. landscape features: trees and shrubs in front yard  
 j. other: \_\_\_\_\_
16. SURROUNDINGS OF THE BUILDING (check more than one if necessary):  
 a. open land  b. woodland   
 c. scattered buildings   
 d. densely built-up  e. commercial   
 f. industrial  g. residential   
 h. other: \_\_\_\_\_

17. INTERRELATIONSHIP OF BUILDING AND SURROUNDINGS:  
 (Indicate if building or structure is in an historic district)

Building is situated on a standard sized lot within Olmsted's Parkside subdivision. House is located one block from Delaware Park, which was designed by Olmsted and is listed on the National Register, and southeast of the Zoo.

18. OTHER NOTABLE FEATURES OF BUILDING AND SITE (including interior features if known):

Two and a half story Colonial Revival style. Hip roof. Through-the-cornice hip roof dormer. Center window with sidelights, 1/1 lights each. End paneled pilaster strips. Off-center projecting entrance with capping cornice. Wood paneled door and molded surround. First floor 1/1 window with surround. Shutters. Second

**SIGNIFICANCE**

19. DATE OF INITIAL CONSTRUCTION: 1905 windows. Entablature with triglyphs decorating the frieze. Building end fluted Doric pilaster strips. South side has rear, pyramidal roofed wing.

ARCHITECT: \_\_\_\_\_

BUILDER: \_\_\_\_\_

20. HISTORICAL AND ARCHITECTURAL IMPORTANCE: The use of Colonial Revival style details provide distinction to the character of this residence. Woodward Avenue runs parallel to Parkside Avenue and extends from Humboldt Avenue to the northwest portion of Crescent Avenue. This street appears on Olmsted's early 1870's maps of "The Parkside," although it is less curvilinear than originally planned. Portions of Woodward Avenue (originally called Davis Avenue) were deeded to the city by five different owners between 1887 and 1892; except for the section north of Amherst, this was done when comparable sections of Crescent Avenue were deeded. Following Olmsted's rule for a suburban street, Woodward Avenue does "not lead with special directness toward town."

21. SOURCES: City Building Permit Records  
 City Tax Assessor Field Sheets  
 Olmsted's Sketch Map of Buffalo, 1876  
 The Papers of Frederick Law Olmsted, Vol. III, by Charles E. Beveridge & David Schuyler, eds. (1983).

22. THEME:

Colonial Revival Details