

BUILDING-STRUCTURE INVENTORY FORM

DIVISION FOR HISTORIC PRESERVATION
 NEW YORK STATE PARKS AND RECREATION
 ALBANY, NEW YORK (518) 474-0479

FOR OFFICE USE ONLY
 UNIQUE SITE NO. 020-40 504 DO7
 QUAD _____
 SERIES _____
 NEG. NO. _____

L

YOUR NAME: BUFFALO FRIENDS OF OLMSTED PARKS DATE: June 5, 1984

P. O. BOX 590

YOUR ADDRESS: BUFFALO, NEW YORK 14205-0590 TELEPHONE: _____

ORGANIZATION (if any): _____

IDENTIFICATION

1. BUILDING NAME(S): _____
2. COUNTY: Erie TOWN/CITY: Buffalo VILLAGE: _____
3. STREET LOCATION: 2450 Main St
4. OWNERSHIP: a. public b. private Main and Jewett
5. PRESENT OWNER: Central Presby. Ch. ADDRESS: Buffalo, NY 14214
6. USE: Original: Residential Present: Residential
7. ACCESSIBILITY TO PUBLIC: Exterior visible from public road: Yes No
 Interior accessible: Explain by permission

DESCRIPTION

8. BUILDING MATERIAL: a. clapboard b. stone c. brick d. board and batten
 e. cobblestone f. shingles g. stucco other: aluminum siding
9. STRUCTURAL SYSTEM: a. wood frame with interlocking joints
 (if known) b. wood frame with light members
 c. masonry load bearing walls
 d. metal (explain) _____
 e. other _____
10. CONDITION: a. excellent b. good c. fair d. deteriorated
11. INTEGRITY: a. original site b. moved if so, when? _____
 c. list major alterations and dates (if known): _____

12. PHOTO: 29-29a



13. MAP:

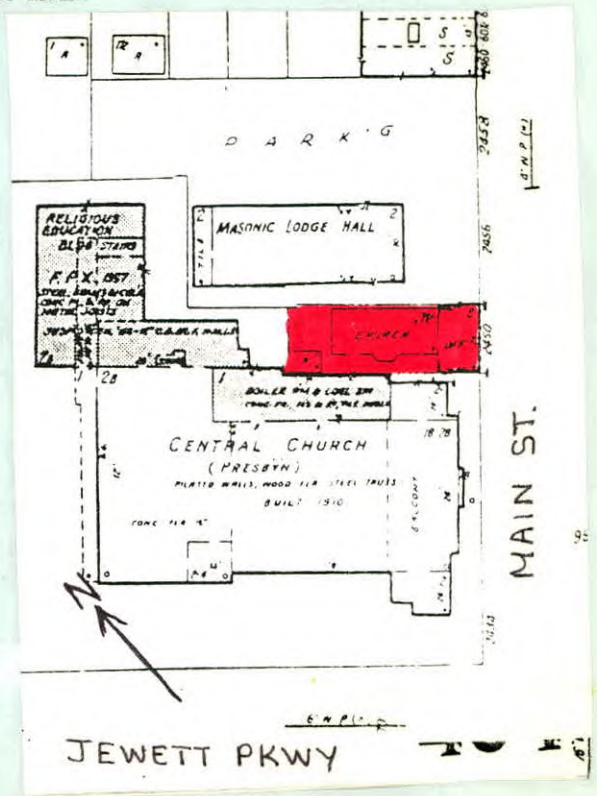

14. THREATS TO BUILDING: a. none known b. zoning c. roads
 d. developers e. deterioration
 f. other: _____
15. RELATED OUTBUILDINGS AND PROPERTY:
 a. barn b. carriage house c. garage
 d. privy e. shed f. greenhouse
 g. shop h. gardens
 i. landscape features: small tree in front yard
 j. other: _____
16. SURROUNDINGS OF THE BUILDING (check more than one if necessary):
 a. open land b. woodland
 c. scattered buildings
 d. densely built-up e. commercial
 f. industrial g. residential
 h. other: _____

17. INTERRELATIONSHIP OF BUILDING AND SURROUNDINGS:
 (Indicate if building or structure is in an historic district)

Building is situated on a small sized lot within Olmsted's Parkside subdivision. It is located four blocks from Delaware Park, which was designed by Olmsted and is listed on the National Register, and east of the Zoo.

18. OTHER NOTABLE FEATURES OF BUILDING AND SITE (including interior features if known):
 Two story Spanish Renaissance style. Side gable roof of red tile stepped end parapets. First floor north end bay has double doors; glass paneled with door grilles. Stone surround. Deeply fluted banded Ionic pilaster strips on pedestal base. Diamond motif decorates base entablature. Semi-circular pediment above entablature. Paneled pilaster strips. Center medallion decorates

SIGNIFICANCE

19. DATE OF INITIAL CONSTRUCTION: c. 1908
 ARCHITECT: 'M.' Pediment flanked by volutes. End ancones. South end bay replicates this devoid of doors.
 BUILDER: Center has Palladian window with spiral engaged columns. Stone circular medallions flank window.

20. HISTORICAL AND ARCHITECTURAL IMPORTANCE: Stone band course at second floor level. Three straight-headed windows; 6/1 lights. Decorative metal rain spouts at building ends.
 An excellent example of a Spanish Renaissance style building attached to residential structure. Originally the Buffalo and Williamsville Macadam Road, Main Street was a pre-existing street at the time Olmsted designated it as the eastern border for "The Parkside." While the streets within the subdivision were designed specifically to avoid commercial development, this portion of Main Street became a combination of commercial and residential structures. It was also a major thoroughfare into the city, allowing easy access to downtown from this suburban neighborhood.
21. SOURCES:
 City Building Permit Records
 City Tax Assessor Field Sheets
 Olmsted's Sketch Map of Buffalo, 1876

22. THEME:
 The Papers of Frederick Law Olmsted, Vol. III, by Charles E. Beveridge & David Schuyler, (eds.), 1983.

Spanish Renaissance