

BUILDING-STRUCTURE INVENTORY FORM

DIVISION FOR HISTORIC PRESERVATION
 NEW YORK STATE PARKS AND RECREATION
 ALBANY, NEW YORK (518) 474-0479

FOR OFFICE USE ONLY
 UNIQUE SITE NO. 028-40 5406
 QUAD _____
 SERIES _____
 NEG. NO. _____

D07

YOUR NAME: BUFFALO FRIENDS OF OLNSTED PARKS DATE: June 5, 1984
 P. O. BOX 590

YOUR ADDRESS: BUFFALO, NEW YORK 14205-0590 TELEPHONE: _____

ORGANIZATION (if any): _____

IDENTIFICATION

1. BUILDING NAME(S): Public School 54
2. COUNTY: Erie TOWN/CITY: Buffalo VILLAGE: _____
3. STREET LOCATION: 2334-2378 Main St
4. OWNERSHIP: a. public b. private 65 Niagara Square
5. PRESENT OWNER: City of Buffalo ADDRESS: Buffalo, NY 14202
6. USE: Original: School Present: School
7. ACCESSIBILITY TO PUBLIC: Exterior visible from public road: Yes No
 Interior accessible: Explain during school hours

DESCRIPTION

8. BUILDING MATERIAL: a. clapboard b. stone c. brick d. board and batten
 e. cobblestone f. shingles g. stucco other: _____
9. STRUCTURAL SYSTEM: a. wood frame with interlocking joints
 (if known) b. wood frame with light members
 c. masonry load bearing walls
 d. metal (explain) _____
 e. other _____
10. CONDITION: a. excellent b. good c. fair d. deteriorated
11. INTEGRITY: a. original site b. moved if so, when? _____
 c. list major alterations and dates (if known): _____

12. PHOTO: 29-24a



13. MAP:

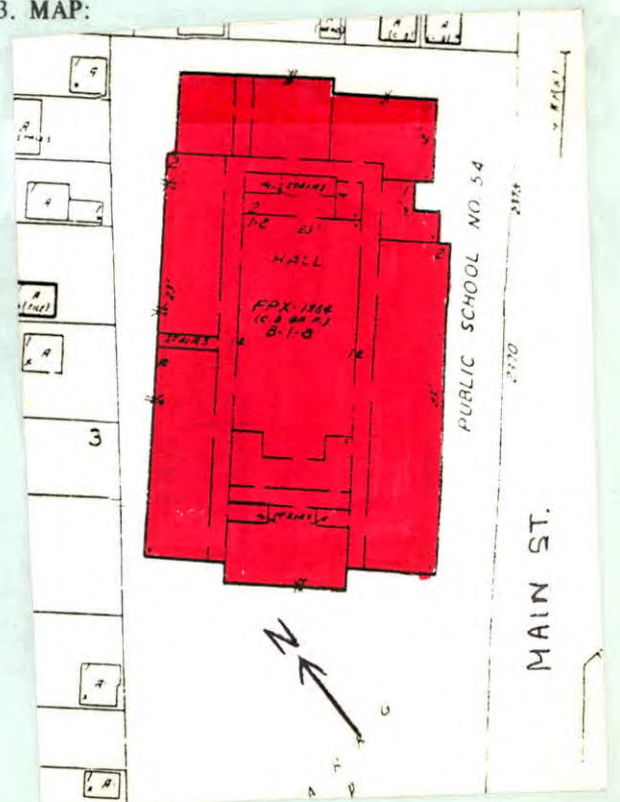

14. THREATS TO BUILDING: a. none known b. zoning c. roads
 d. developers e. deterioration
 f. other: _____
15. RELATED OUTBUILDINGS AND PROPERTY:
 a. barn b. carriage house c. garage
 d. privy e. shed f. greenhouse
 g. shop h. gardens
 i. landscape features: trees in front
 j. other: _____
16. SURROUNDINGS OF THE BUILDING (check more than one if necessary):
 a. open land b. woodland
 c. scattered buildings
 d. densely built-up e. commercial
 f. industrial g. residential
 h. other: large parking lot

17. INTERRELATIONSHIP OF BUILDING AND SURROUNDINGS:
 (Indicate if building or structure is in an historic district)

Building is situated on a very large city lot within Olmsted's Parkside subdivision. School is located four blocks from Delaware Park, which was designed by Olmsted and is listed on the National Register, and southeast of the Zoo.

18. OTHER NOTABLE FEATURES OF BUILDING AND SITE (including interior features if known):

Two story contemporary style brick school. Flat roof. Main block of building is 6 bays long. Each bay has four 3-part louvred single light windows on first and second floor. Vertical strips forming pilasters flank windows. Brown brick panels alternate with concrete panels. To north of main block is one-story recessed entrance with flat plane roof supported by two metal structural

SIGNIFICANCE

19. DATE OF INITIAL CONSTRUCTION: 1964
 ARCHITECT: curved bases. Pair double glass doors. One-story wing extends from entrance to north. Brown brick offset by shallow recessed panels of yellow brick. 9-light square louvred-style windows.
 BUILDER: supports with flared

20. HISTORICAL AND ARCHITECTURAL IMPORTANCE: The vernacular version of Modern style applied to school structure. Originally the Buffalo and Williamsville Macadam Road, Main Street was a pre-existing street at the time Olmsted designated it as the eastern border for "The Parkside." While the streets within the subdivision were designed specifically to avoid commercial development, this portion of Main Street became a combination of commercial and residential structures. It was also a major thoroughfare into the city, allowing easy access to downtown from this suburban neighborhood.

21. SOURCES: City Building Permit Records
 Olmsted's Sketch Map of Buffalo, 1876
 The Papers of Frederick Law Olmsted, Vol. III, by Charles E. Beveridge & David Schuyler, eds. (1983).
22. THEME: Modern