

BUILDING-STRUCTURE INVENTORY FORM

DIVISION FOR HISTORIC PRESERVATION
NEW YORK STATE PARKS AND RECREATION
ALBANY, NEW YORK (518) 474-0479

FOR OFFICE USE ONLY	
UNIQUE SITE NO. <u>029-40</u>	<u>5650</u> <u>D07</u>
QUAD _____	_____
SERIES _____	_____
NEG. NO. _____	_____

YOUR NAME: Debra A. Mattice DATE: August 7, 1984

YOUR ADDRESS: 37 Congress, Bflo 14213 TELEPHONE: (716) 884-5899

ORGANIZATION (if any): City of Buffalo - Division of Planning

IDENTIFICATION

- 1. BUILDING NAME(S): _____
- 2. COUNTY: Erie TOWN/CITY: Buffalo VILLAGE: _____
- 3. STREET LOCATION: 65 Tillinghast Pl
- 4. OWNERSHIP: a. public b. private
- 5. PRESENT OWNER: Philip Zeidenberg ADDRESS: 65 Tillinghast Place, Bflo
- 6. USE: Original: Residence Present: Residence
- 7. ACCESSIBILITY TO PUBLIC: Exterior visible from public road: Yes No
Interior accessible: Explain By Permission

DESCRIPTION

- 8. BUILDING MATERIAL: a. clapboard b. stone c. brick d. board and batten
e. cobblestone f. shingles g. stucco other: Siding
- 9. STRUCTURAL SYSTEM: a. wood frame with interlocking joints
(if known) b. wood frame with light members
c. masonry load bearing walls
d. metal (explain) _____
e. other _____
- 10. CONDITION: a. excellent b. good c. fair d. deteriorated
- 11. INTEGRITY: a. original site b. moved if so, when? _____
c. list major alterations and dates (if known): _____

12. PHOTO: 40-10a

13. MAP:

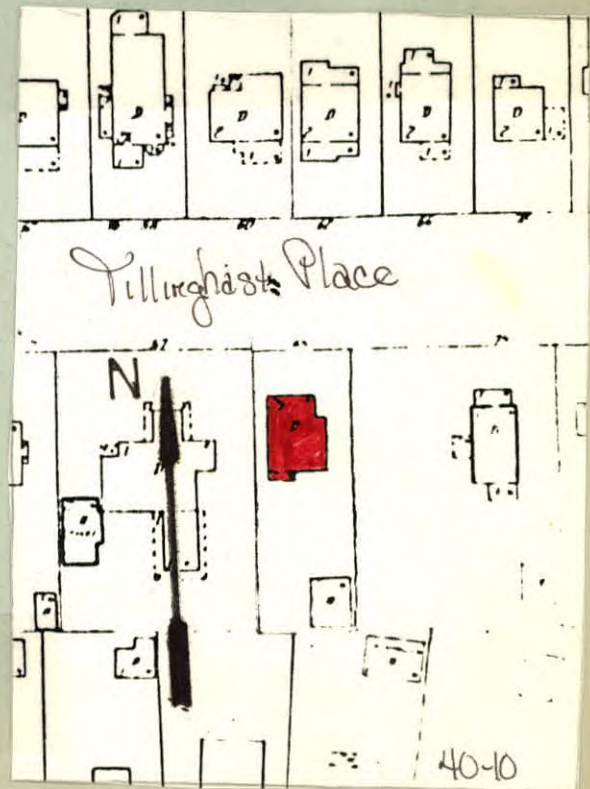

14. THREATS TO BUILDING: a. none known b. zoning c. roads
 d. developers e. deterioration
 f. other: _____
15. RELATED OUTBUILDINGS AND PROPERTY:
 a. barn b. carriage house c. garage
 d. privy e. shed f. greenhouse
 g. shop h. gardens
 i. landscape features: _____
 j. other: _____
16. SURROUNDINGS OF THE BUILDING (check more than one if necessary):
 a. open land b. woodland
 c. scattered buildings
 d. densely built-up e. commercial
 f. industrial g. residential
 h. other: _____

17. INTERRELATIONSHIP OF BUILDING AND SURROUNDINGS:
 (Indicate if building or structure is in an historic district)

This building is located in the center of a long curvilinear east-west block, situated on a large size building lot within Omsted's Parkside subdivision. Single family residences, c. 1915; Prairie, Craftsman, with moderate size front lawns line this street. The grounds of the Buffalo Zoological Society are located one block to the south.

18. OTHER NOTABLE FEATURES OF BUILDING AND SITE (including interior features if known):

Two and one half story with Tudor influence, Hip roof, Projecting gabled second story overhand on front facade. First floor four part window, casement with 9 lights each. Second floor has a set of paired double hung 4/4 windows, Gable has double sash, 6 lights each, window. West side has gabled bay with recessed entrance. Wood paneled door.

SIGNIFICANCE

19. DATE OF INITIAL CONSTRUCTION: _____ 1915 _____

ARCHITECT: _____

BUILDER: _____

20. HISTORICAL AND ARCHITECTURAL IMPORTANCE:

This residence is an example of a simplified vernacular Tudor style. It's estimated cost for construction was \$6,000. The street takes its name from James Tillinghast, owner of the property up until July 15, 1889 when it was conveyed to George L. Thorne and Byron Angell, to be subdivided for residential use. The subdivision named "Meadow View Park" carried restrictive covenants in its deeds of sale. The restrictions set forth minimum house costs and minimum distances for street frontage. The homes on Tillinghast were to be of "tasteful design" and the cost was not to be less than \$3,000. The street reflects Olmsted's philosophy regarding roadways located within a subdivision; Tillinghast is a broad, long roadway with no intersecting thoroughfares, running east to west "with no special directness toward the town."

21. SOURCES: Atlas of the City of Buffalo, 1894, 1915.

City of Buffalo, Department of Building Permits: Building Plans (A-57) 1915.

Deed - Liber 575, Page 143; Conveyance with restrictive covenants

The Papers of Frederick Law Olmsted Vol III., pg. 265

22. THEME:

Residential architecture associated with Parkside development

Tudor Style