

BUILDING-STRUCTURE INVENTORY FORM

DIVISION FOR HISTORIC PRESERVATION
NEW YORK STATE PARKS AND RECREATION
ALBANY, NEW YORK (518) 474-0479

FOR OFFICE USE ONLY

029-40

DO7

UNIQUE SITE NO. 4784
QUAD _____
SERIES _____
NEG. NO. _____

YOUR NAME: BUFFALO FRIENDS OF OLMSTED PARKS DATE: May 25, 1983

P. O. BOX 590

YOUR ADDRESS: BUFFALO, NEW YORK 14205-0590 TELEPHONE: _____

ORGANIZATION (if any): _____

IDENTIFICATION

- 1. BUILDING NAME(S): _____
- 2. COUNTY: Erie TOWN/CITY Buffalo VILLAGE: _____
- 3. STREET LOCATION: 1380 Amherst St.
- 4. OWNERSHIP: a. public b. private
- 5. PRESENT OWNER: Morton Zandler ADDRESS: 1380 Amherst St.
- 6. USE: Original: Residential Present: Residential
- 7. ACCESSIBILITY TO PUBLIC: Exterior visible from public road: Yes No
Interior accessible: Explain by permission

DESCRIPTION

- 8. BUILDING MATERIAL: a. clapboard b. stone c. brick d. board and batten
e. cobblestone f. shingles g. stucco other: _____
- 9. STRUCTURAL SYSTEM: (if known) a. wood frame with interlocking joints
b. wood frame with light members
c. masonry load bearing walls
d. metal (explain) _____
e. other _____
- 10. CONDITION: a. excellent b. good c. fair d. deteriorated
- 11. INTEGRITY: a. original site b. moved if so, when? _____
c. list major alterations and dates (if known): _____

12. PHOTO: 17-9a



13. MAP:

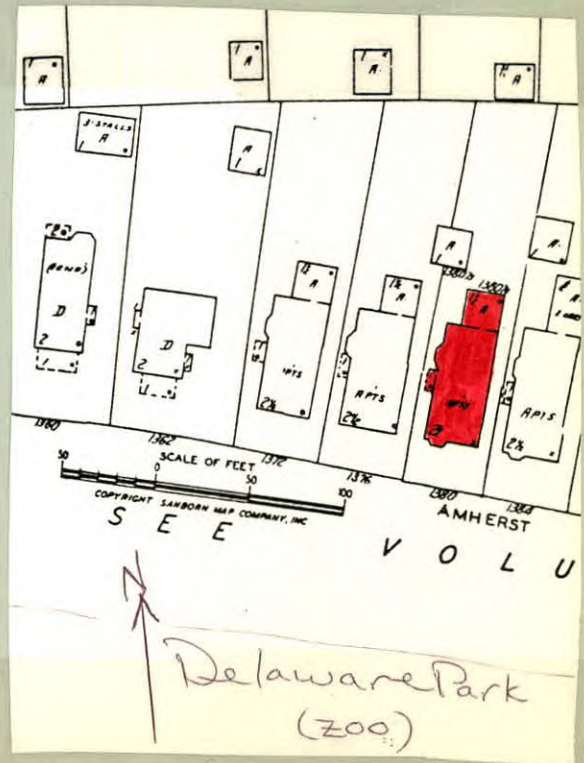

14. THREATS TO BUILDING: a. none known b. zoning c. roads
d. developers e. deterioration
f. other: _____

15. RELATED OUTBUILDINGS AND PROPERTY:
a. barn b. carriage house c. garage
d. privy e. shed f. greenhouse
g. shop h. gardens
i. landscape features: large trees in front of house, shrubs
j. other: _____

16. SURROUNDINGS OF THE BUILDING (check more than one if necessary):
a. open land b. woodland
c. scattered buildings
d. densely built-up e. commercial
f. industrial g. residential
h. other: _____

17. INTERRELATIONSHIP OF BUILDING AND SURROUNDINGS:

(Indicate if building or structure is in an historic district)

Building is situated on a standard sized building lot within Olmsted's Parkside subdivision. House is directly opposite Delaware Park which was designed by FLO and is listed on the National Register. A dense grove of trees and the Buffalo Zoo are across the street from this property.

18. OTHER NOTABLE FEATURES OF BUILDING AND SITE (including interior features if known):
Two story frame apartment building. Gable roof. Two six light over single pane windows in gable. Two story bay towards the rear of the west facade and on the west side of the front facade. Double hung single pane windows. Entrance on west side of house has sidelight and a simple frame overdoor. Brick foundation.

SIGNIFICANCE

19. DATE OF INITIAL CONSTRUCTION: c. 1915

ARCHITECT: _____

BUILDER: _____

20. HISTORICAL AND ARCHITECTURAL IMPORTANCE:

One on seven two story apartment buildings on the section of Amherst St. between Colvin and Parkside. This section of Amherst Street, between Colvin and Parkside, was conceived by FLO around 1873 as part of a residential "suburb" adjacent to Delaware Park. This suburb was called "The Parkside" by Olmsted and appears on an 1876 map drawn by him as a proposed area of curved winding streets on the north and east sides of the park. This section of Amherst St. was actually created by the City of Buffalo in 1875 when Amherst St. was extended from Delaware Ave. to Main St.. The street follows Olmsted's original plan maintaining the picturesque character that he envisioned for the streets surrounding the park.

21. SOURCES: Buffalo City Atlas 1894, 1915
Sandborn Map 1916
Buffalo Index to Streets @1896
FLO's original map for "Parkside"

22. THEME:

Apartment Building