

**BUILDING-STRUCTURE INVENTORY FORM**

DIVISION FOR HISTORIC PRESERVATION  
NEW YORK STATE PARKS AND RECREATION  
ALBANY, NEW YORK (518) 474-0479

FOR OFFICE USE ONLY	
UNIQUE SITE NO.	<u>029-40-5857</u>
QUAD	_____
SERIES	_____
NEG. NO.	_____

DO7

YOUR NAME: BUFFALO FRIENDS OF OLMSTED PARKS DATE: August 6, 1984

P. O. BOX 590

YOUR ADDRESS: BUFFALO, NEW YORK 14205-0590 TELEPHONE: \_\_\_\_\_

ORGANIZATION (if any): \_\_\_\_\_

\*\*\*\*\*

**IDENTIFICATION**

- BUILDING NAME(S): \_\_\_\_\_
- COUNTY: Erie TOWN/CITY: Buffalo VILLAGE: \_\_\_\_\_
- STREET LOCATION: 34 Willow Lawn
- OWNERSHIP: a. public  b. private
- PRESENT OWNER: Louis Scholl ADDRESS: 34 Willow Lawn
- USE: Original: Residential Present: Residential
- ACCESSIBILITY TO PUBLIC: Exterior visible from public road: Yes  No   
Interior accessible: Explain by permission

**DESCRIPTION**

- BUILDING MATERIAL: a. clapboard  b. stone  c. brick  d. board and batten   
e. cobblestone  f. shingles  g. stucco  other: \_\_\_\_\_
- STRUCTURAL SYSTEM: a. wood frame with interlocking joints   
(if known) b. wood frame with light members   
c. masonry load bearing walls   
d. metal (explain) \_\_\_\_\_  
e. other \_\_\_\_\_
- CONDITION: a. excellent  b. good  c. fair  d. deteriorated
- INTEGRITY: a. original site  b. moved  if so, when? \_\_\_\_\_  
c. list major alterations and dates (if known): \_\_\_\_\_

12. PHOTO: 39-20a



13. MAP:

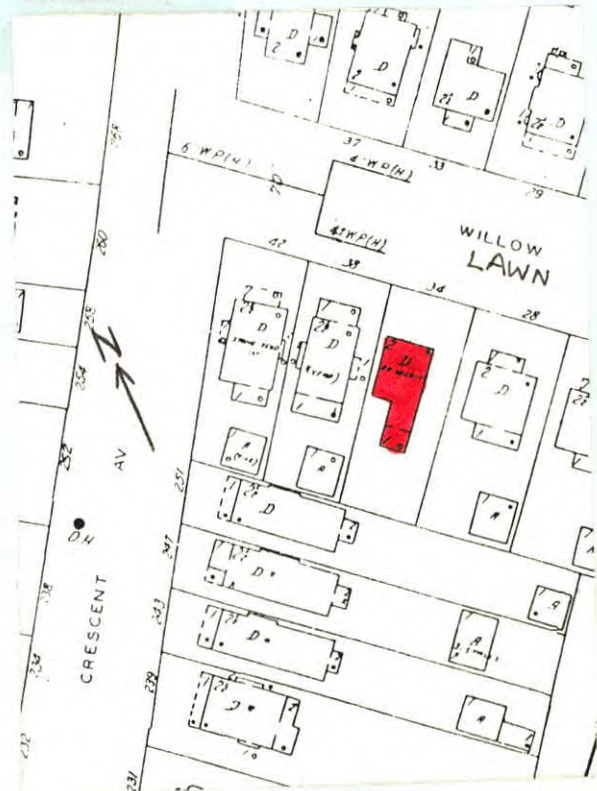

14. THREATS TO BUILDING: a. none known  b. zoning  c. roads   
 d. developers  e. deterioration   
 f. other: \_\_\_\_\_
15. RELATED OUTBUILDINGS AND PROPERTY:  
 a. barn  b. carriage house  c. garage   
 d. privy  e. shed  f. greenhouse   
 g. shop  h. gardens   
 i. landscape features: trees and shrubs in front yard  
 j. other: \_\_\_\_\_
16. SURROUNDINGS OF THE BUILDING (check more than one if necessary):  
 a. open land  b. woodland   
 c. scattered buildings   
 d. densely built-up  e. commercial   
 f. industrial  g. residential   
 h. other: \_\_\_\_\_

17. INTERRELATIONSHIP OF BUILDING AND SURROUNDINGS:  
 (Indicate if building or structure is in an historic district)

Building is situated on a standard sized lot within Olmsted's Parkside subdivision. House is located four blocks from Delaware Park, which was designed by Olmsted and is listed on the National Register, and southeast of the Zoo.

18. OTHER NOTABLE FEATURES OF BUILDING AND SITE (including interior features if known):

Two and a half story American Four Square form. Hip roof with modillion brackets under projecting eave. Brick first floor. Frame boxed oriel with curved bracket supports. Three double-hung 1/1 windows. Leaded transom. Entablature. Right bay first floor has double-hung 1/1 window. Stone lintel. Band course at second floor level. Frame second floor with vertical stick styling. Left bay has double-hung

SIGNIFICANCE

19. DATE OF INITIAL CONSTRUCTION: 1907 1/1 window. Right bay boxed oriel. Double hung 1/1 window. Plain window surround. Hip roof dormer has three double-hung 1/1 windows. East side gabled entrance hood with triangular bracket support. Wood paneled entrance with sidelights.

20. HISTORICAL AND ARCHITECTURAL IMPORTANCE: An American Four Square with Colonial Revival styling. Willow Lawn, a one-block street between Crescent Avenue and Main Street just south of Jewett Parkway, is located on the lands of Elam R. Jewett and was named after the Jewett homestead. The last street to be created in the eastern portion of the Parkside subdivision, Willow Lawn was deeded to the city by Jewett's widow in 1905. It is the only Parkside street with a grassy median. While this specific street does not appear on Olmsted's 1870's maps of "The Parkside," it follows Olmsted's subdivision rule of providing easy access to a major thoroughfare leading toward downtown.

21. SOURCES: City Building Permit Records  
 City Tax Assessor Field Sheets  
 Olmsted's Sketch Map of Buffalo, 1876  
 The Papers of Frederick Law Olmsted, Vol. III, by Charles E. Beveridge & David Schuyler, eds. (1983).
22. THEME:

American Four Square/ Colonial Revival Styling