

BUILDING-STRUCTURE INVENTORY FORM

DIVISION FOR HISTORIC PRESERVATION
NEW YORK STATE PARKS AND RECREATION
ALBANY, NEW YORK (518) 474-0479

FOR OFFICE USE ONLY

029-40

DO7

UNIQUE SITE NO. 5217
QUAD _____
SERIES _____
NEG. NO. _____

YOUR NAME: BUFFALO FRIENDS OF OLMTED PARKS DATE: May 25, 1983

P. O. BOX 590

YOUR ADDRESS: BUFFALO, NEW YORK 14205 - 0590 TELEPHONE: _____

ORGANIZATION (if any): _____

IDENTIFICATION

- 1. BUILDING NAME(S): _____
- 2. COUNTY: Erie TOWN/CITY: Buffalo VILLAGE: _____
- 3. STREET LOCATION: 31 Jewett Pkwy
- 4. OWNERSHIP: a. public b. private
- 5. PRESENT OWNER: Arthur G. Doyle ADDRESS: 31 Jewett Parkway
- 6. USE: Original: Residential Present: Residential
- 7. ACCESSIBILITY TO PUBLIC: Exterior visible from public road: Yes No
Interior accessible: Explain by permission

DESCRIPTION

- 8. BUILDING MATERIAL: a. clapboard b. stone c. brick d. board and batten
e. cobblestone f. shingles g. stucco other: _____
- 9. STRUCTURAL SYSTEM: a. wood frame with interlocking joints
(if known) b. wood frame with light members
c. masonry load bearing walls
d. metal (explain) _____
e. other _____
- 10. CONDITION: a. excellent b. good c. fair d. deteriorated
- 11. INTEGRITY: a. original site b. moved if so,when? _____
c. list major alterations and dates (if known): _____

12. PHOTO: 18-14a



HP-1

13. MAP:

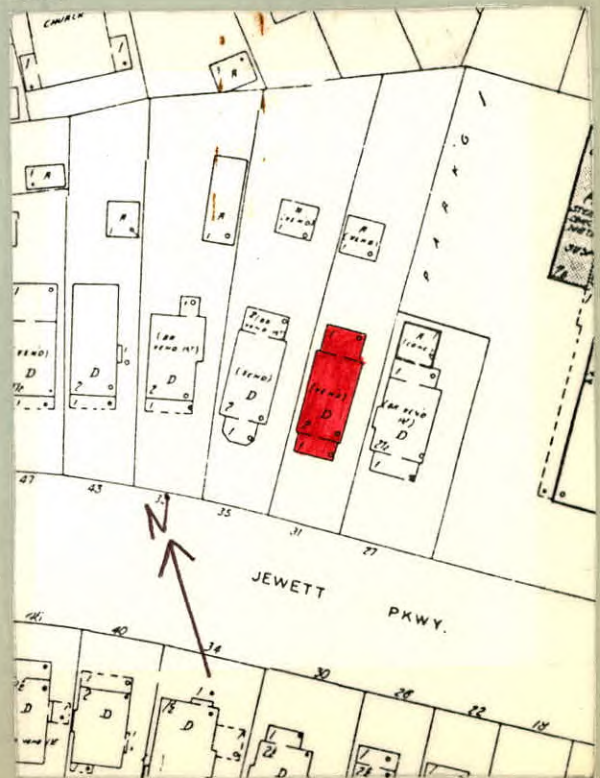

14. THREATS TO BUILDING: a. none known b. zoning c. roads
d. developers e. deterioration
f. other: _____
15. RELATED OUTBUILDINGS AND PROPERTY:
a. barn b. carriage house c. garage
d. privy e. shed f. greenhouse
g. shop h. gardens
i. landscape features: Large evergreen in front yard. Red
j. other: maple tree at street.
16. SURROUNDINGS OF THE BUILDING (check more than one if necessary):
a. open land b. woodland
c. scattered buildings
d. densely built-up e. commercial
f. industrial g. residential
h. other: _____

17. INTERRELATIONSHIP OF BUILDING AND SURROUNDINGS:
(Indicate if building or structure is in an historic district) Building is situated on a standard sized building lot within Olmsted's Parkside subdivision. House is four blocks to the east of Delaware Park which was designed by F.L.O. and is listed on the National Register.

18. OTHER NOTABLE FEATURES OF BUILDING AND SITE (including interior features if known):
Two story Colonial Revival style. Gable roof. Two gabled dormers on east side of house. Exterior chimney on front of house. Two small windows on either side of the chimney, in gable. Enclosed porch across front of house has brick piers. Single pane windows with six light transom windows in porch. House has eight light over single pane windows. Entrance on east side of house has a metal overdoor.

SIGNIFICANCE

19. DATE OF INITIAL CONSTRUCTION: c.1920

ARCHITECT: _____

BUILDER: _____

20. HISTORICAL AND ARCHITECTURAL IMPORTANCE:
Typical example of an early 20th century Colonial Revival style house that was built in the Parkside neighborhood. Jewett Parkway was originally opened in 1875 by Elam R. Jewett whose estate was at the southwest corner of Main Street and Jewett Parkway. The street followed Olmsted's plan for the Parkside neighborhood and can be seen on his 1876 map of the City of Buffalo. In 1884 Elam Jewett deeded the street to the City of Buffalo, "on condition that it shall be placed in charge of the Park Commissioners and be by then maintained as a Park approach, in the same manner as the other Park approaches now are or hereafter may be maintained."

21. SOURCES: Buffalo City Atlas 1915
Sandborn Map 1925
City of Buffalo - Park Reports 1884 "Olmsted's Sketch Map of Buffalo Showing the Relation of the Park System." 1876
22. THEME: Colonial Revival